

# BRILLIANCE AND VERSATILITY IN A COMPACT LIGHTWEIGHT BODY.

**EPSON**  
EXCEED YOUR VISION



EB-PU1006W / PU1007W



EB-PU1008B / PU2010B

**Brighter and better in a lightweight, compact, and durable body with Epson's PU-series.**

Presenting Epson's PU-series projectors, now with brightness of up to 10,000 lumens. With a more lightweight and compact body, along with an easy stacking function, this series is engineered to offer flexibility and convenience from small to large requirements. With the new NFC function, fuss-free mass kitting and settings are made easier using the Epson Projector Config mobile app.

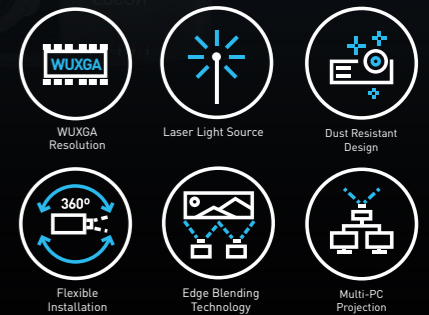

Find out more at [www.epson.com.sg/projectors](http://www.epson.com.sg/projectors)

epsonsg EpsonSingapore EpsonSoutheastAsia Epson Southeast Asia

Epson Singapore Pte Ltd 438B Alexandra Road, Block B Alexandra Technopark, #04-01/04, Singapore 119968, Tel: (65) 6586-5500  
Epson Customer Care Center 100G Pasir Panjang Road, #01-09 Interlocal Centre, Singapore 118523. Epson Helpdesk: 800 120 5564. Please refer to [www.epson.com.sg/contact](http://www.epson.com.sg/contact) for opening hours.

Information correct at time of printing. Printed October 2021.

### Improved Brightness

Picture clarity and sharpness guaranteed with up to 10,000\* lumens in brightness, suitable from small to large venues.

### Installation Flexibility

Limitless staging possibilities with a new easy stacking function, complete with an external dust-resistant air filter.

### Better Assets Management

Built-in NFC helps reduce setup time and users can read and write setting information seamlessly using the Epson Projector Config Tool app on mobile.

\*Brightness will vary from 6,000 - 10,000lm depending on model. Please refer to product specification sheet at the back.



# DYNAMIC, DURABLE. YET COMPACT.

Projecting up to 10,000 lumens of high brightness, the Epson's PU-series of projectors has something for every need from boardroom meetings and conferences to public displays and large-scale events. With a durable easy stacking body, the projectors come complete with a super-resolution and detail enhancement function, delivering crisp and sharp images onto large screens.



EB-PU2010B is 27% smaller in size versus EB-L1495UNL.\*  
\*Calculations based on dimensions excluding feet.

## Revolutionary 4 in 1 Laser Package\*

Equipped with this new laser package, EB-PU2010B delivers 10,000 lumens of equal white and colour brightness in a compact, lightweight chassis. This allows for easier and more discreet installations as well as increased transportability.

\*All PU-Series are equipped with the new laser package.

## Fuss-free Stackable Possibilities

With its easy stacking build, the PU-series can be stacked using lesser equipment, quicker and easier, shortening both installation time and manpower required.

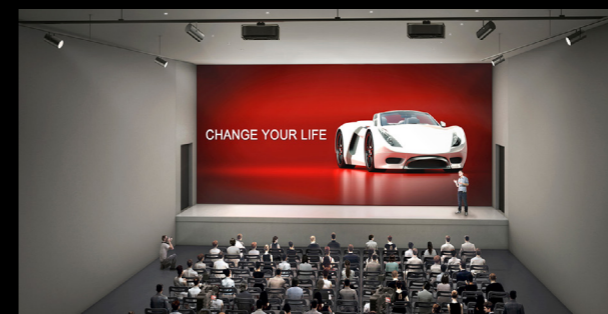

## Versatility and Flexibility

With its durable and compact body, you can easily place the PU-series at your convenience, projecting on large screens at high brightness according to your needs.

	EB-PU1006W	EB-PU1007W	EB-PU1008B	EB-PU2010B
BRIGHTNESS	6,000 lm	7,000 lm	8,500 lm	10,000 lm
RESOLUTION	WUXGA, 1920 x 1200			
SUPPORT 4K ENHANCEMENT	●	●	●	●
CONTRAST RATIO	> 2,500,000 : 1			
LIGHT HOURS	20,000 Hrs			
LENS SHIFT	VERTICAL ±67° HORIZONTAL ±30°			VERTICAL ±60° HORIZONTAL ±18° (Powered with Standard Lens)
INPUT TERMINALS	1x VGA / 1x HDMI (HDCP 2.3) / 1x DVI-D (HDCP 1.4) / 1x HDBaseT (HDCP 2.3)			1x VGA / 1x HDMI (HDCP 2.3) / 1x DVI-D (HDCP 1.4) / 1x HDBaseT (HDCP 2.3) / 1x SDI
OUTPUT TERMINALS	1x Audio Out			
CONTROL	1x RS-232C			



# ILLUMINATING AND ENGAGING.

Go bold with the world's leading projector brand with Epson PU-series. With up to 10,000 lumens brightness, these projectors meet all your business needs for crisp, sharp, clear images for meetings and conferences to delivering stimulating, immersive visual experience to liven up your staging events.



## 4K Enhancement

Delivers crisp, sharp images for an immersive, mesmerising experience with 4K enhancement.



## High Image Quality with Epson 3LCD Advantage



With Epson's proprietary 3LCD technology, projected images are up to 3X brighter vs 1 chip DLP projectors. A up to 3X wider colour gamut with no rainbow effect also ensures brilliant and faithful colour reproduction and a more comfortable viewing experience.



Up to **3X** Brighter Colors  
with Epson Projectors



## High Dynamic Range for Superior Resolution

These projectors support HDR10 and Hybrid Log-Gamma to provide more precise detailing for light and dark graduation contents, as well as more vibrant images and improved contrast.



SDR (Standard Dynamic Range)



HDR (High Dynamic Range)

## High Contrast Ratio

With a 1920 x 1200 WUXGA resolution and high contrast of >2,500,000:1, you can now fully depict gradations even in dark-toned images. Down to the tiniest detail on a large screen, captivate your audience with vivid clarity and sharpness for an immersive and dynamic viewing experience.

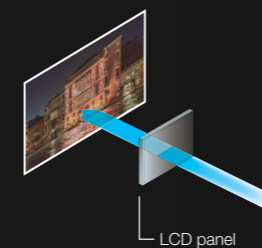

Without special optical parts

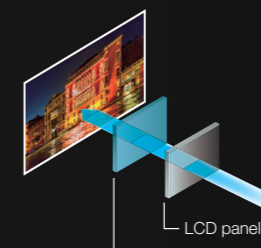

With special optical parts

## Advanced Colour Adjustment

Easily adjust the hue, saturation, and brightness for each component of RGBCMY to suit your preferences with the advanced colour adjustment function.

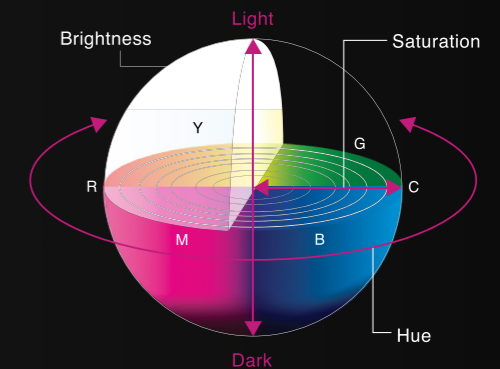

## Scene Adaptive Gamma Correction

This unique image quality adjustment feature analyses the display content frame by frame and automatically adjusts the gamma level of the displayed content for optimum contrast and more natural looking projected images.

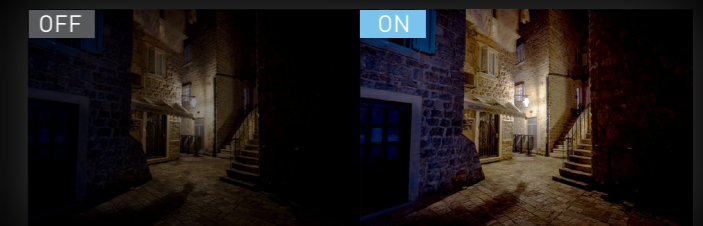
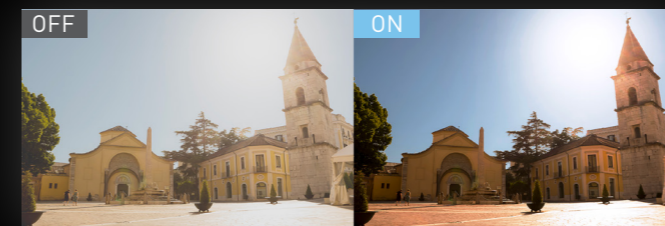



# FUSS-FREE VERSATILITY.

Enjoy the ease of stackability with the PU-series' easy stacking build, using lesser equipment and shorter installation time to achieve your ideal projections. Gain more with in-built functions such as Geometry Correction Assist for Stacking and Tiling Function, Auto Colour Calibration and unleash an abundance of possibilities with the PU-series.



## Easy Stacking Function

Stack easily with a remote controller from the OSD menu instead of the conventional PC, or wi-fi router, done quickly using the daisy chain by SDI signal IN/OUT support<sup>1</sup>, reducing hassle and installation time. Alternatively, take advantage of the Auto Camera Assist for stacking to reduce installation time to a mere five minutes without additional fuss.

### Conventional Setup

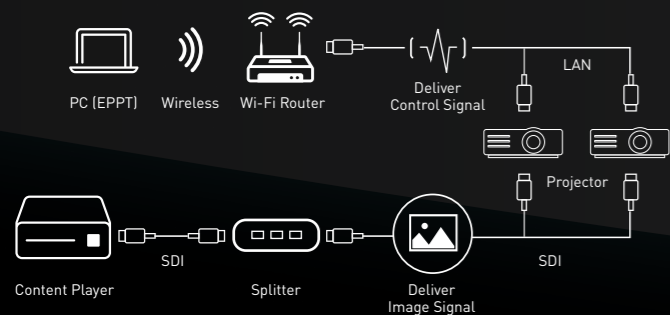

### EB-PU2010B

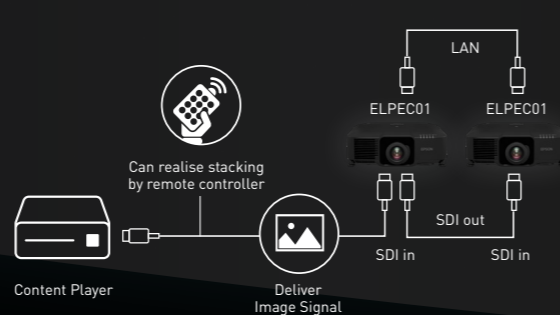

## ELPEC01 Optional Camera

The ELPEC01's flexible mounting positions allow for quick adjustments to the camera, as well as usage with ultra short throw lens, thanks to its small size. When used together with the Epson Professional Tool software, both setup and usage for multiple projectors will be a fuss-free process.



## Geometry Correction Assist for Stacking Function\*

Stack two projectors easily and quickly with the Geometry Correction Assist function, making full use of the PU-series' easy stacking function, to project even larger images without losing its sharpness.

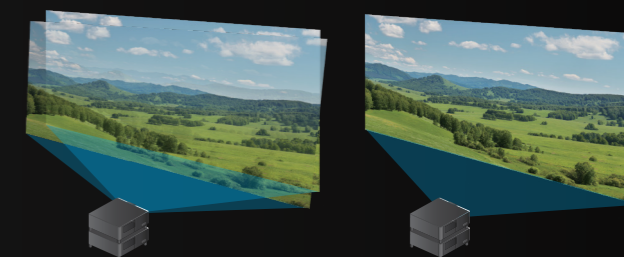

## Auto Colour Calibration<sup>2</sup>

Detecting screens that became unevenly coloured over time, the camera allows the projector to automatically correct colour and detecting subtle colour inconsistencies between multiple projectors. You can program it to check colour manually or automatically at regular intervals to deliver stable image quality with minimum maintenance.

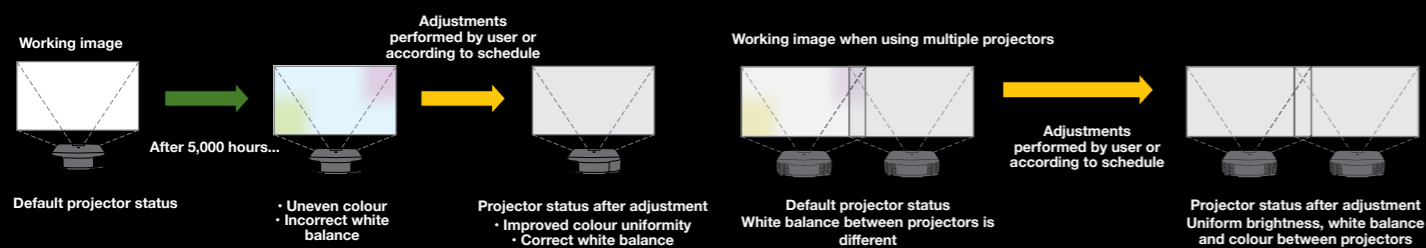

## Geometry Correction Assist for Tiling Function\*

Take advantage of the Auto Tiling Assist function, which will allow you to showcase sharp and impressive supersized images with edge blending, mesmerising your audience with every projection. The function also corrects the image shape when projecting on a flat surface, enhancing the overall visual experience.

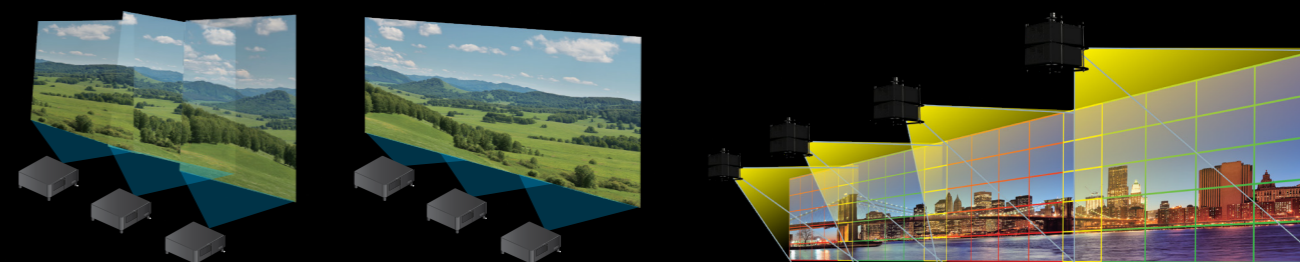

<sup>1</sup> Only for EB-PU2010B. Requires HDMI splitter for EB-PU1000 series. <sup>2</sup> Function with optional camera module.

\*Function with optional camera module.



# DIFFERENT ENVIRONMENT. SAME IDEAL PROJECTOR.

An ideal projector for use in various environments, Epson's PU-series of projectors suit a wide variety of interchangeable lens, allowing projection on curved and corner spaces, along with the ability to project borderless multi-directional projections. The optional external filter increases the dust resistance to further minimise maintenance even in high dusty environments for a worry-free projection.

## Multi-Directional Projections

Ideal for a wide range of applications including projecting onto ceilings and curved surfaces, the PU-series can be rotated 360° in any direction, be it horizontally, vertically or rotationally, without loss in image brightness, bringing forth a clear and crisp visual to your audience.



## Borderless Multi-Projection

With a wide variety of functions available for multi-projector installations, you can adjust the brightness, colour and position of overlapping areas for seamless, beautiful displays with the PU-series of projectors.

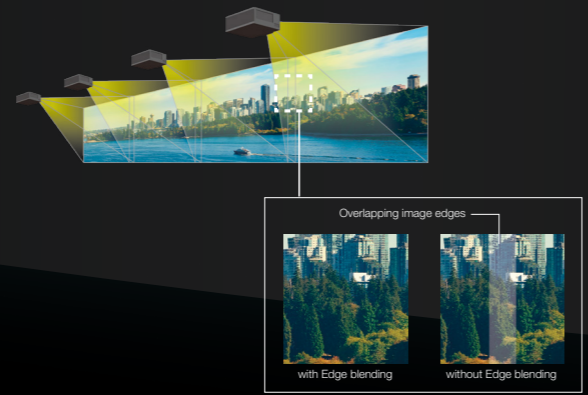

## Powered Lens with Stepping Motor

The powered lens with stepping motor offer limitless possibilities in projector placement. Covering a wide range of angles, the motorised lens shift gives you a great deal of flexibility when installing the projector. The newly adopted stepping motor lets you make highly precise adjustments when employing edge blending, stacking and other techniques. Adjustments can also be made via remote control or over a network, enhancing usability even for ceiling-mounted projectors.

## External Air Filter

Coupled with the external air filter, the PU-series will reduce the maintenance intervals even in high dust environments such as shopping malls and exhibitions.



## Wider Lens Shift Range

With a wider lens shift range, the PU-series has a more precise adjustment to suit an abundance of possibilities in projector placement.

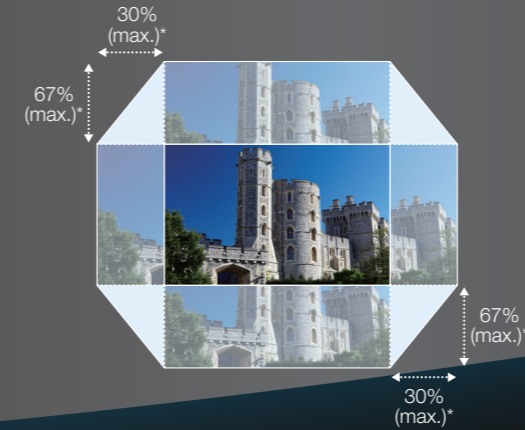

\*Using standard lens. Except for EB-PU2010B which is only V=60% and H=18%.

## Projection on Wide, Curved, and Corner Spaces

Impress with projections that can fit perfectly even on non-flat surfaces. Create eye-catching vivid projections on wide curved surfaces and corner walls, effective for captivating advertisements, promotions, and marketing.

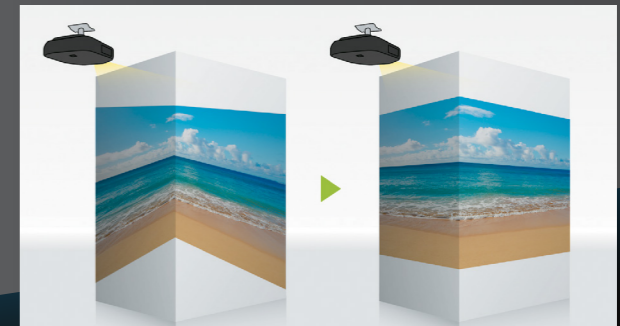

## Extensive Lens Line-up

PU-series supports Epson's existing range of lens, allowing you to project in any space. This includes the zero offset UST lens and zero offset lens, which are especially useful to transform even the most compact spaces.

LENS	THROW RATIO	0.0	1.0	2.0	3.0	4.0	5.0	6.0	7.0	8.0	9.0	10.0
ELPLL08							7.21-10.11	5.27-7.41				
ELPLM11									4.85-7.38	3.54-5.41		
ELPLM10								3.32-5.06	2.42-3.71			
ELPLM15									2.16-3.48	1.57-2.56		
ELPLM08									1.44-2.32			
ELPLW06									1.62-2.22	1.19-1.62		
ELPLW08									1.18-1.66	0.86-1.21		
ELPLW05									1.04-1.46	0.77-1.07		
ELPLU04									0.87-1.05	0.64-0.77		
ELPLU03S									0.65-0.78	0.48-0.57		
ELPLX02S									0.35			
ELPLX01S/ ELPLX01WS*									0.35			

Legend: EB-PU1000 Series (Red), EB-PU2010B (Blue)

\* ELPLX01WS is in white.





# BETTER MANAGEMENT. WITHOUT HASSLE.

Hassle-free projector management and easier setup are made possible with Epson's suite of professional tools. Manage your fleet of projectors and handle mass kitting with the Epson Projector Config Tool, achieve seamless edge blending and more with Epson Projector Professional Tool, and stay in control remotely with the Epson Projector Management Software.



## Epson Projector Config Tool for Easy Set Up

Using NFC wireless communications technology to change projector settings and check equipment information, the Epson Projector Config Tool is an app that allows you to configure network and projection settings in advance, even when the projector is switched off. Allowing management across your fleet of projectors, this tool helps to reduce time and effort required, increasing efficiency.



Initial setting comparison of using USB memory and Epson Projector Config Tool in warehouse.

### ✗ 10 steps in 67 minutes

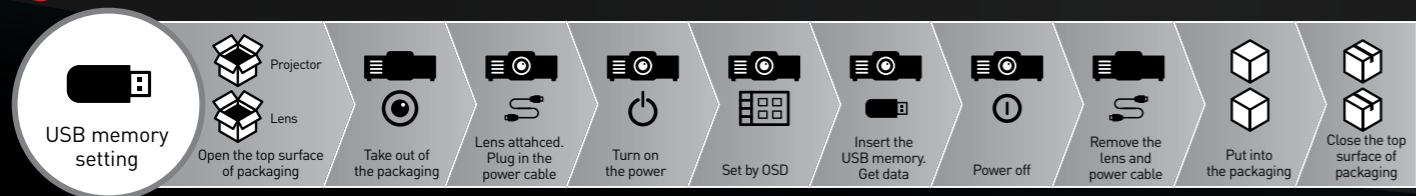

### ✓ Just 5 steps in 7 minutes\*

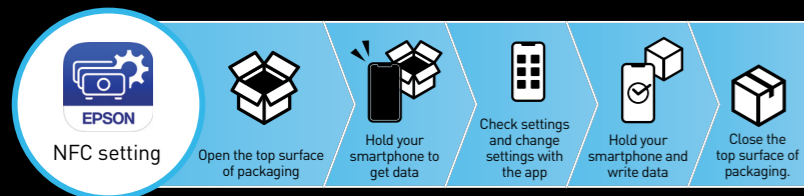

Reduce the number of steps by **50%**  
and save **1-hour** of your time  
VS using USB memory setting!\*



\*Based on Epson's internal acceleration tests.



## Epson Projector Professional Tool

Match projected images' borders to project a vivid and clear supersized image with the Epson Projector Professional Tool. With the tool, settings that previously required separate remote controller operations for each projector can also all be done on a single PC, greatly reducing installation time and effort.

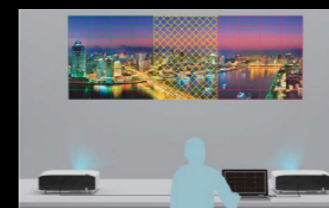

## Epson Projector Management Software

Reduce manpower needed by staying in control remotely with the Epson Projector Management Software. You can now check the status of all the projectors from one computer by connecting multiple Epson projectors to a network. The software also incorporates a message-broadcasting plug-in to send messages to Epson projectors over the network, and has the ability to power down all Epson projectors in the building after working hours.

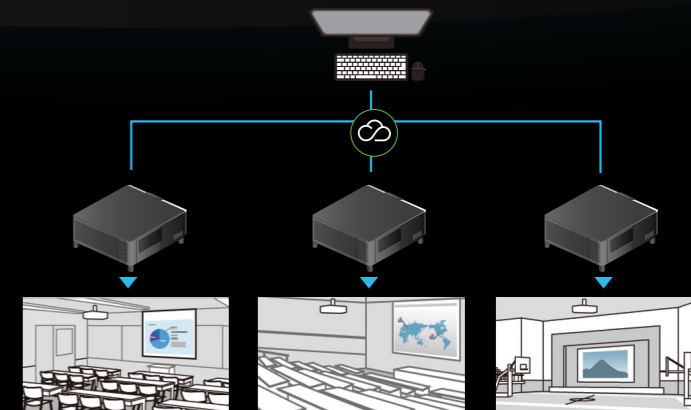

Note: Some functions do not support Epson Professional Tool. Network connection is a requirement for use of Epson Professional Tool.

# Unveil The True Colours

EPSON 3LCD PROJECTORS

1-CHIP PROJECTORS

**True BRIGHTNESS**

**True COMFORT**

**True REALISM**

Up to 3x  
Brighter Colours

No Rainbow  
Effect

3x Wider  
Colour Gamut



WHITE 3000 LUMENS  
 COLOUR 3000 LUMENS



WHITE 3000 LUMENS  
 COLOUR 430 LUMENS\*\*



LIGHT SOURCE  
 PRISM



LIGHT SOURCE  
 ROTATING COLOUR WHEEL



WIDER COLOUR RANGE



SMALLER COLOUR RANGE

**SPECIFICATIONS**

MODEL NUMBER	EB-PU1006W   PU1007W   PU1008B	EB-PU2010B
<b>Projection Technology</b>	RGB liquid crystal shutter projection system (3LCD)	
<b>Specifications of Main Parts</b>		
LCD	0.76" (C2 Fine)	1.0" (C2 Fine)
Resolution	WUXGA (Support 4K Enhancement)	
Aspect Ratio	16:10	
Projection Lens	Power Zoom, Power Focus	
Type		
F-Number	1.7 - 2.3	1.8 - 2.3
Focal Length	24 - 38.2 mm	36 - 57.4 mm
Zoom Ratio	1.0 - 1.60	
Throw Ratio	1.44 - 2.32 (Wide - Tele)	1.57 - 2.56 (Wide - Tele)
Vertical Lens Shift	Vertical: ±67% (Powered)	Vertical: ±60% (Powered)
Horizontal Lens Shift	Horizontal: ±30% (Powered)	Horizontal: ±18% (Powered)
Lightsources	Laser Diode	
Type		
Life	20,000 hours (Normal) / 30,000 hours (Extended)	
<b>Screen Size (Projected Distance)</b>		
Zoom: Wide	50" - 1,000" [1.53 - 31.57 m]	60" - 1,000" [1.99 - 34.43 m]
Zoom: Tele	50" - 1,000" [2.48 - 50.44 m]	60" - 1,000" [3.26 - 55.63 m]
<b>Brightness<sup>1</sup></b>		
White Light Output	6,000 lm / 7,000 lm / 8,500 lm	10,000 lm
Colour Light Output (Normal)	6,000 lm / 7,000 lm / 8,500 lm	10,000 lm
Light Output (Centre) <sup>2</sup>	6,500 lm / 7,500 lm / 9,200 lm	10,300 lm
<b>Contrast Ratio</b>	Over 2,500,000:1	
<b>Keystone Correction</b>		
Projection Orientation	360° Free	
Vertical / Horizontal	±45° / ±30°	
<b>Connectivity</b>		
Analog RGB Input	D-Sub 15Pin	1
Digital Input	SDI (SD/HD/3G-SDI)	N/A
	HDMI	Yes (BNC)
	DVI-D	1 (HDCP 2.3)
	HDBaseT	1 (HDCP 1.4)
	USB Type A	1 (HDCP 2.3)
USB Input	2 (Port1 for 5V/2A Power Supply, Grackle, SMF1, Firmware Update, Copy OSD Settings, Content Playback ; Port2 for 5V/900mA Power Supply, Wireless LAN, Firmware Update, Copy OSD Settings, Content Playback)	
Control I/O	USB Type B	1 (For Firmware Update, Copy OSD Settings)
	RS-232C	D-Sub 9pin x 1
	Remote	1
Digital Output	SDI (SD/HD/3G-SDI)	N/A
	Stereo Mini	Yes (BNC)
Audio Output	Wired LAN	
Network	Optional Wireless	ELPAP11
<b>Wireless Specification</b>		
Supported Speed for Each mode	Infrastructure: IEEE 802.11b (2.4GHz): 11 Mbps <sup>3</sup> , IEEE 802.11g (2.4GHz): 54 Mbps <sup>3</sup> , IEEE 802.11n (2.4GHz): 72.2 Mbps <sup>3</sup> , IEEE 802.11a (5GHz): 54 Mbps <sup>3</sup> , IEEE 802.11n (5GHz): 150 Mbps <sup>3</sup> Access Point (Wi-Fi Direct): IEEE 802.11g (2.4GHz): 54 Mbps <sup>3</sup> , IEEE 802.11n (2.4GHz): 72.2 Mbps <sup>3</sup> , IEEE 802.11a (5GHz): 54 Mbps <sup>3</sup> , IEEE 802.11n (5GHz): 150 Mbps <sup>3</sup> Infrastructure, Access Point (Wi-Fi Direct)	
Supported Mode	Infrastructure, Access Point (Wi-Fi Direct)	
Supported Security Type	Infrastructure: Open, WPA2 / WPA3-PSK, WPA2 / WPA3-EAP Supported EAP Type: PEAP, PEAP-TLS, EAP-TLS, EAP-Fast Access Point (Wi-Fi Direct): WPA2-PSK (AES)	
<b>Operating Temperature</b>		
Single Use	Low Altitude (0 - 2,286m/7,500ft): 0 - 45 °C <32 - 113 °F> High Altitude (Over 2,286m/7,500ft): 0 - 40 °C <32 - 104 °F> 20% - 80% Humidity, No Condensation	Low Altitude (0 - 2,286m/7,500ft): 0 - 50 °C <32 - 122 °F> High Altitude (Over 2,286m/7,500ft): 0 - 45 °C <32 - 113 °F> 20% - 80% Humidity, No Condensation
<b>Operating Altitude</b>	Over 1,500m/4,921ft with High Altitude Mode: 0 - 3,048m (0 - 10,000ft)	
<b>Direct Power On / Off</b>	Yes	
<b>Start-Up Period</b>	Less than 7 seconds (Epson Logo); Warm-up Period: 30 sec	
<b>Quick Start-Up</b>	Less than 7 seconds (Display)	
<b>Cool Down Period</b>	Instant Off	
<b>Air Filter</b>	Type	Electrostatic Filter
	Maintenance Cycle <sup>4</sup>	20,000 hours (Normal) / 30,000 hours (Extended)
<b>Power Supply Voltage</b>	100 - 240 V AC ±10%, 50/60 Hz	
<b>Power Consumption (220 - 240V)</b>		
Laser Diode On	Normal	367 W   431 W   535 W
	Extended	310 W   366 W   452 W
	Standby (Normal / Eco)	2.0 W / 0.5 W
<b>Dimension Excluding Feet (DXWXH)</b>	436 x 545 x 164 mm	
<b>Weight</b>	Approx. 15.4kg / 16.3kg / 16.3kg	
<b>Fan Noise (Normal / Medium / Eco)</b>	EB-PU1006W: 30dB / 29dB / 28dB EB-PU1007W: 33dB / 31dB / 29dB EB-PU1008B: 35dB / 34dB / 30dB	Approx. 16.8kg 37dB / 34dB / 30dB

**Supplied Accessories**

- Power Cable: 3m
- Remote Control: Yes, with Alkaline AA Battery
- Cable cover
- Lens Connector Cap
- User Guide

**Optional Accessories**

- Air Filter: ELPAF46
- External Air Filter: ELPAP63
- External Camera: ELPEC01
- Wireless LAN unit: ELPAP11
- Ceiling Mount: ELPPF15\*
- Extension Pole: ELPPF15\*
- HDBaseT Transmitter: ELPHD01

\*Can be fitted with ELPMB67 mount for high ceiling applications.

EB-PU1006W / PU1007W



EB-PU1008B



EB-PU2010B



**EPSON 3LCD PROJECTORS**

**1-CHIP PROJECTORS**



Scan here to find out more

All images for illustrative purposes only, actual performance of the projectors may vary.



Find out more at [www.epson.com.sg/projectors](http://www.epson.com.sg/projectors)

epsonsg EpsonSingapore EpsonSoutheastAsia Epson Southeast Asia

Epson Singapore Pte Ltd 438B Alexandra Road, Block B Alexandra Technopark, #04-01/04, Singapore 119968. Tel: (65) 6586-5500  
Epson Customer Care Center 100G Pasir Panjang Road, #01-09 Interlocal Centre, Singapore 118523. Epson Helpdesk: 800 120 5564. Please refer to [www.epson.com.sg/contact](http://www.epson.com.sg/contact) for opening hours.

©2021 Epson Singapore Pte Ltd. All Rights Reserved. Reproduction in part or in whole, without the written permission from Epson, is strictly prohibited.

EPSON and EXCEED YOUR VISION are registered trademarks of Seiko Epson Corporation.

All other product names and other company names used herein are for identification purposes only and are the trademarks or registered trademarks of their respective owners.

Epson disclaims any and all rights in those marks. Projected images shown herein are simulations. The actual product design and contents may vary. Specifications are subject to change without notice and may vary between countries. Please check with local Epson offices for more information.

Apple, iPad and iPhone are trademarks of Apple Inc., registered in the U.S. and other countries. App Store is a service mark of Apple Inc.

Android is a trademark of Google Inc.

Dealer's Stamp

Information correct at time of printing.  
Printed October 2021

<sup>1</sup> Colour brightness (colour light output) and white brightness (white light output) will vary depending on usage conditions. Colour light output measured in accordance with IDMS 15:4; white light output measured in accordance with ISO 21118.  
<sup>2</sup> This light output value is measured at the centre of the screen as a reference value. There is no official standard for light output (Centre) measurements and this measurement is made based on the method set by Epson.  
<sup>3</sup> These modes and actual data throughputs depend on supported wireless mode of source devices and/or environment conditions.  
<sup>4</sup> When used in the general office environment (the amount of floating dust: 0.04 - 0.2 mg/m<sup>3</sup>). Based on the Epson's in-house test results.

